



*FACTORBIKES.COM*

ALL CONTENT CONTAINED HEREIN IS TO BE CONSIDERED CONFIDENTIAL AND NOT FOR REPRODUCTION. IMAGES MAY BE  
COPYRIGHTED BY OTHERS AND ARE NOT TO BE REPRODUCED.



**FACTOR**

**LANDO**

**XC**

**HT**





## Customer Profile

Discerning mountain bike customer who prioritizes genuine performance over marketing and appreciates fine details.

Less “**Duuuude, Broooo; more Strava**”



Use cases could be:

- Road racer gone MTB
- Endurance MTB racer (leadville, Cape Epic, etc)
- Gravel racer cross-over
- Elite/WC MTB racer





## MTB Product spec

### Key features

- Internal cable routing
- 120 or 100mm front travel
- 100-115mm rear travel (kinematic/package based)
- Single Pivot with tuned flex at stay, using a linkage driven shock and a common pivot for the shock and chainstay linkage
- 1x only
- Sram Universal RDH
- Room for bottle in DT
- 2.4" Tire clearance (with Mud)
- Boost Spacing Front and rear
- 31.6 Seatpost
- T47x 85.5mm BB



# LANDO<sup>XC</sup>

Colour Options:

Lando XC Crystal Green



## Kinematic Narrative

- Forward swingarm pivot flattens the anti-squat curve
- High performance riders need to have predictable suspension behaviour regardless of what gear they're in, they don't only climb in the 52 tooth
- sub 100% antisquat allows the suspension to remain active when applying power, but keeping the values in the 90%+ range means the suspension will stay firm.
- Anti-Rise of less than 80% also ensures that brake jack is kept to a minimum
- Shared Shock and lower swing arm pivot mounted as wide as possible ensure the simplest, lightest and strongest use of the available frame material.
- Mono-box Chainstay bridge radically increases stiffness
- flexible seat stays give four bar performance without the extra weight and complication of additional pivot points
- One piece molded rocker link maximizes stiffness and eliminates side loading on shock, extending shock life, and radically decreasing stiction





## 34T-Kinematic Design

- Extremely flat Anti-Squat across all gears
- Slightly below 'industry standard' giving a more active suspension
- intended to be coupled with a lockout
- All AS curves intersect at recommended sag setting
- Very low Kickback angle
- Linear behaviour, somewhat progressive. Some riders may want to fit a volume reducing spacer if they desire more progressive behaviour

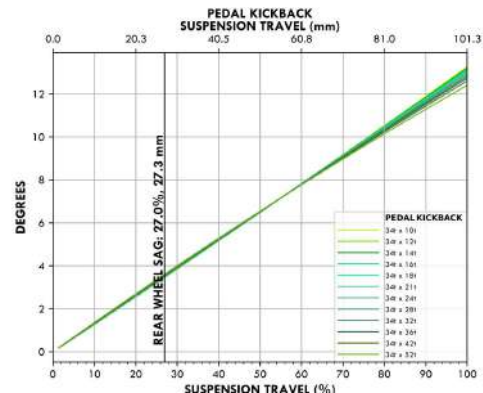
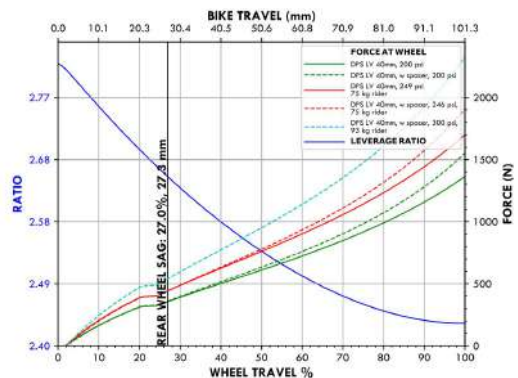
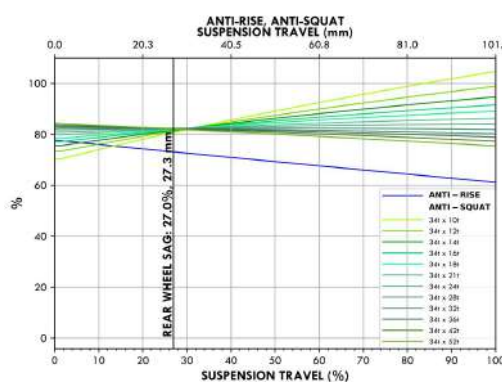



## 32T-Kinematic Design

- Maintains Extremely flat Anti-Squat across all gears
- AS goes up somewhat with the smaller sized ring, likely obviating the need for a lockout for those that don't want one
- intended to be coupled with a lockout

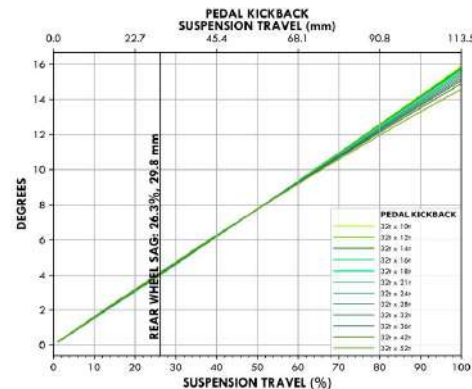
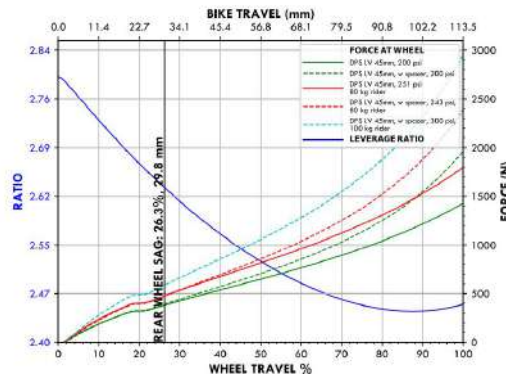
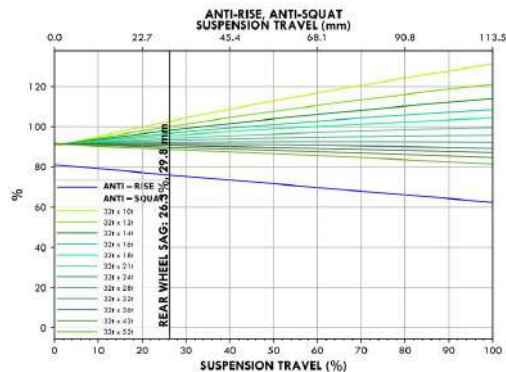

## Progressive and Modern Geometry

- 67 Degree HTA coupled with a 120mm travel fork let you move back and drive on technical terrain
- 75.5 Degree STA coupled with a zero offset seat post allow the rider to bring their knee over the pedal spindle to emphasize high power output.
- Long top tube coupled with a relatively short stem keep the riders C of G well over the rear end of the bike
- Balanced Rear Center length with trail gives predictable handling behaviour



## Trail Geo, size Large

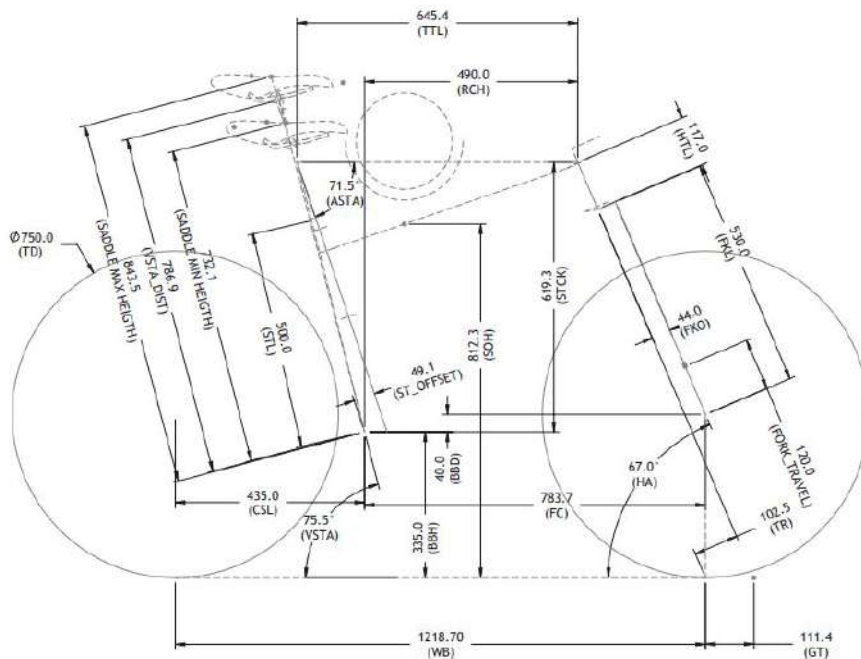

	120 Travel	Small	Medium	Large	X-Large
Stack	594.5	599.0	608.0	619.0	
Reach	410.0	430.0	460.0	490.0	
HTA	67.0	67.0	67.0	67.0	
VSTA	75.5	75.5	75.5	75.2	
CSL	435.0	435.0	435.0	435.0	
BB Drop	40.0	40.0	40.0	40.0	
Fork Length	530.0	530.0	530.0	530.0	
Offset	51.0	51.0	51.0	51.0	
WB	1128.0	1150.0	1184.0	1218.0	
SOH	725.0	770.0	781.0	812.0	
Trail	95.5	95.5	95.5	95.5	
HT Length	90.0	95.0	105.0	118.0	
Max Saddle	712.0	756.0	800.0	844.0	
Min Saddle	612.0	652.0	692.0	732.0	



## Detail Design



## Detail Design

Vertically orientated shock allows for the shock forces to be concentrated at the already very strong BB area, and significantly lightening the Top tube. Top tube gusset allows for very good standover height without needing to dramatically thicken the ST itself, also contributing to low weight.



## Detail Design

Split Seat tube allows for the use of a monobox Chainstay connection, giving excellent torsional stiffness and low weight. The shock is nested into the front side of the ST for a sleek and unique look, sharing its pivots with the rear triangle. The Shared pivots are directly mounted into the frame itself giving a super stiff, well aligned interface for the entire system to ride on.

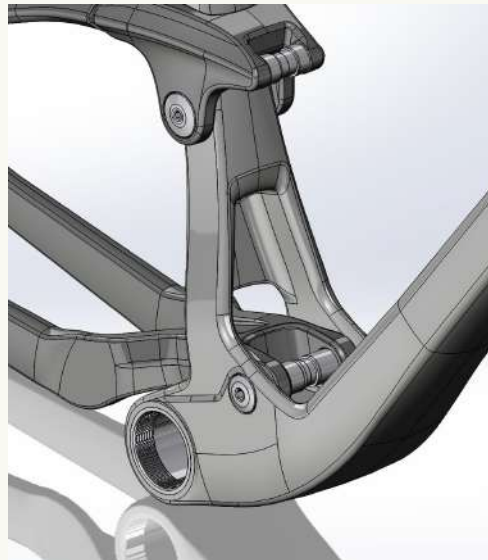



## Detail Design

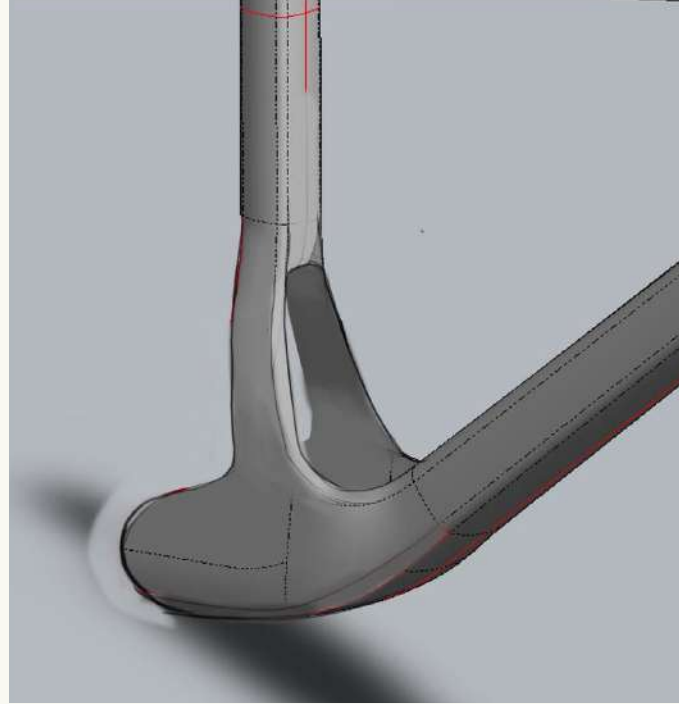
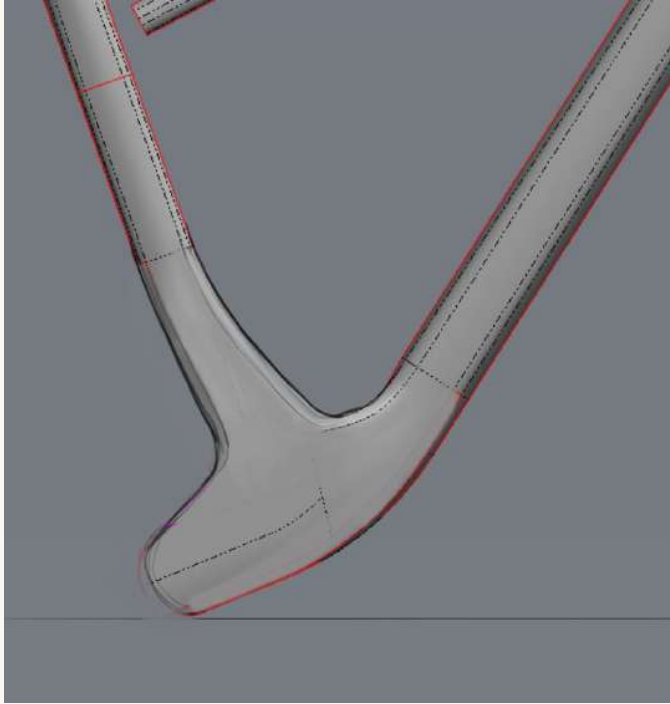

## Detail Design

The one piece molded carbon rocker is extremely stiff, preventing any sideloading on the shock which dramatically extends its life span, and decreases sticktion when in use.

All fasteners possible are blind or from the NDS, giving a sleek and blended look to the system. The design is intended to evoke the signature factor SS blends found on the Vista, Ostro and LS.

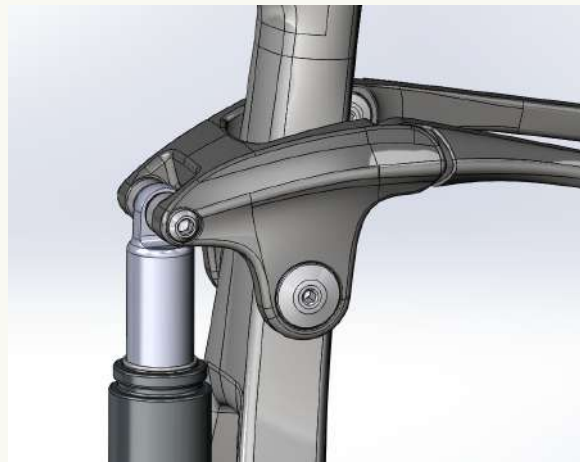
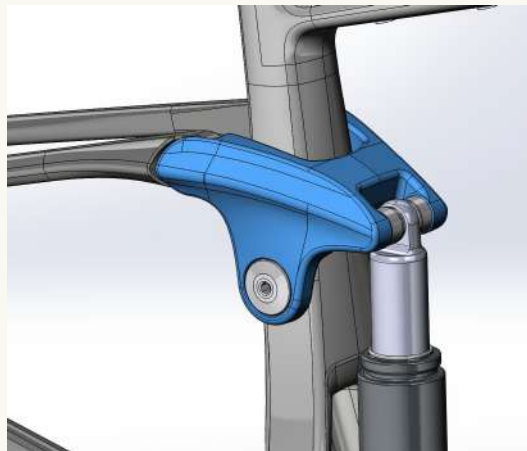

## Detail Design

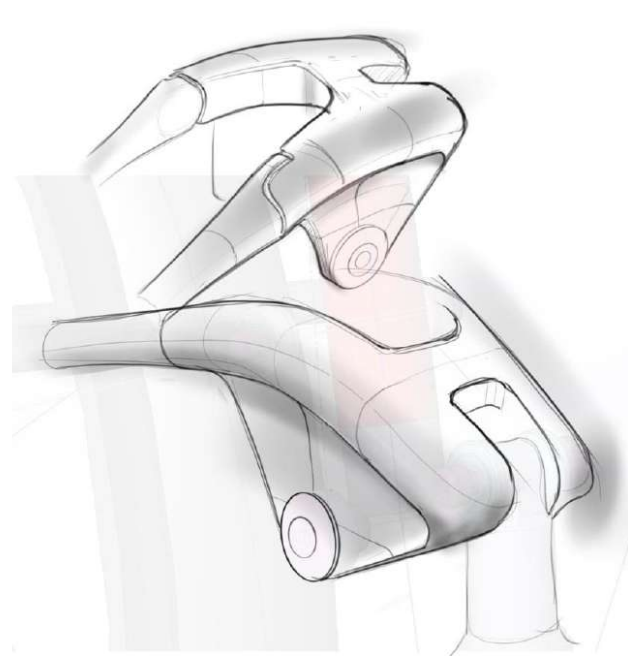
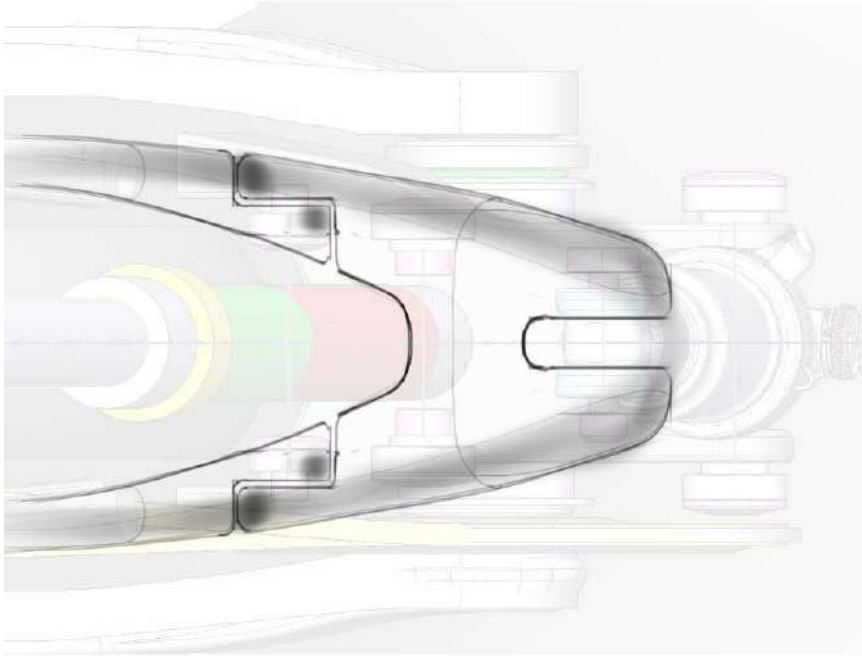



## Detail Design

The single piece left and right chainstay/seatstay assembly has been highly refined for ultra light weight, as well as stiffness. By keeping the entire assembly as a single piece the bearing alignment is improved leading to longer pivot bearing life in the system.

A flat mount rear brake reduces the weight significantly and allows for the removal of all metal inserts in the chain stay.

It also facilitates the symmetrical seatstay configuration which keeps the loads being transmitted from the rear wheel symmetrical which helps with shock alignment.

Sram's UDH is used on the drive side to allow for future upgrades to direct mount RD's. Full mechanical routing is supported.



## Detail Design

Industry leading T47 BB brought to MTB's for the convenience and piece of mind of a threaded BB, with the benefits of full width 1x boost spacing and access to 30mm cranks, as well as native support for shimano 24mm cranks

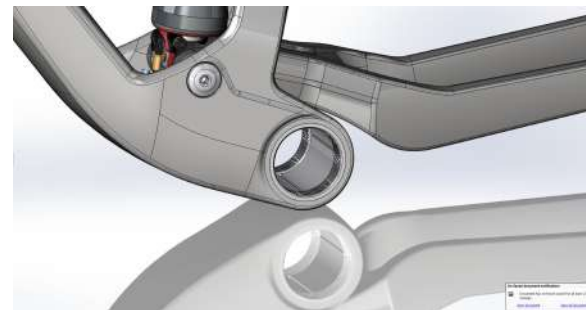

## Cable Routing

- Both Internal and external options for hydraulic hoses
- Note mechanical not internal compatible

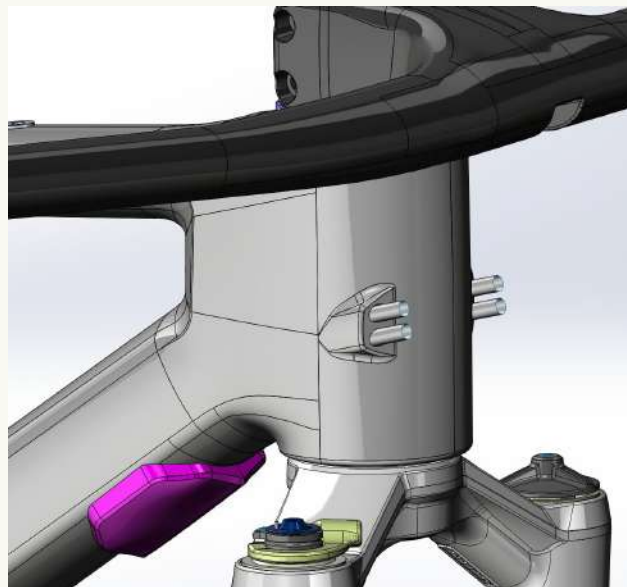
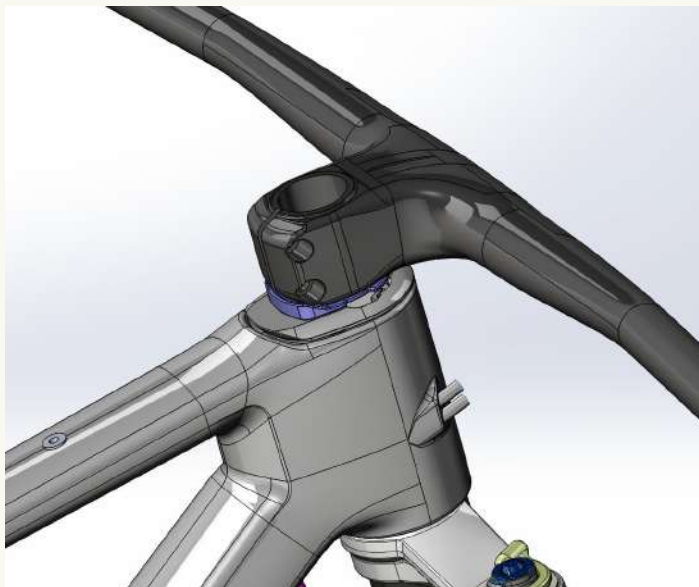

## Cable Routing

- Internal dropper and rear lockout routing

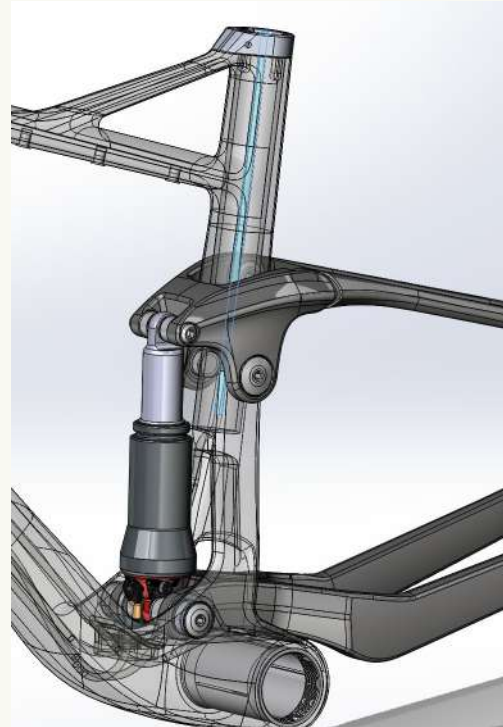
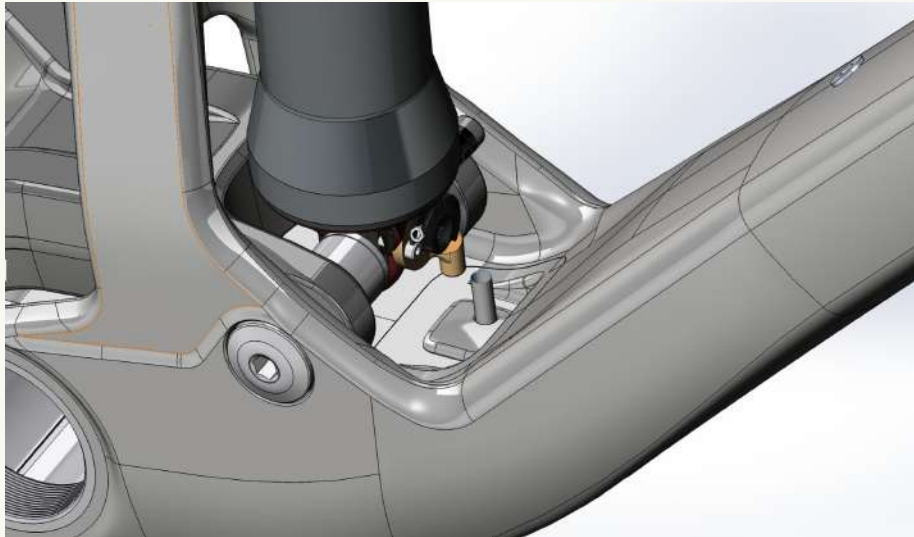



## Mounting points

- Triple DT bottle bosses
- Under HT tool and accessory mounting
- “Bento” style mounts behind HT

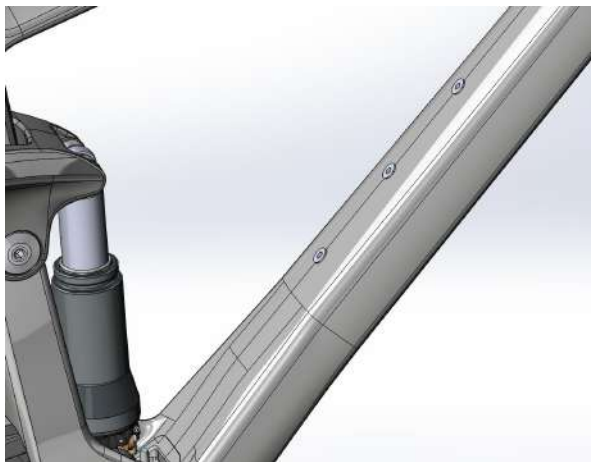

## Design Details

- Sleek and integrated SP clamp for a standard 31.6 seat post
- Mechanically attached anti rotation guard
- Full length DT protector

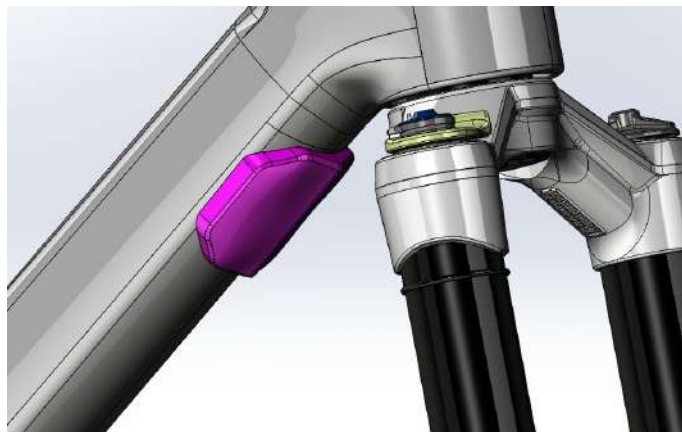
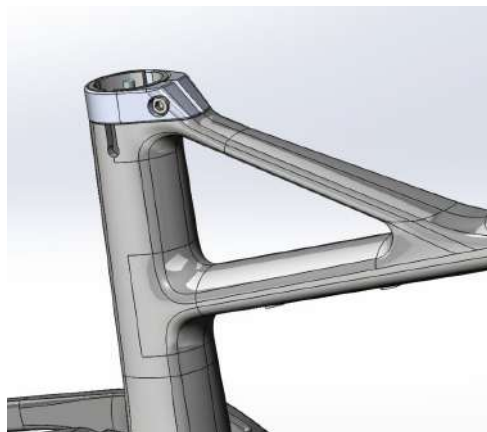

## 2kg Frame, Shock & Hardware

FT	1044.5
RT	577.5
Link	191.5
Shock	245.0
Pivot hardware	90.0
Shock upper bolt	22.0
Seatpost clamp	22.5
	2193.0
LW FT Version	-185.0
	2008.0



# LANDO<sup>HT</sup>

Colour Options:

Lando X Naked carbon (Rigid)





# **LANDO<sup>HT</sup>**

The Lando HT is the hardtail mountain bike of choice for the discerning XC rider looking to maximize their

speed and race times. The ultra lightweight frame and advanced design features result in world class performance.

An exceptional stiffness-to-weight ratio and modern geometry ensures it's at home scaling the climbs and attacking the descents.



# LANDO<sup>HT</sup>

- 67110mm Travel or Fully Rigid
- Boost 1x drive train, with T47 threaded BB
- Integrated internal hose routing, with optional conventional routing.
- Minimalist UL frame with exceptional stiffness to weight
- Mating Black Inc Twenty-Seven wheels, one piece barstem, 2 bolt seat post, and hidden go pro compatible computer mount
- 2.4" Tire clearance, 31.6 Seat Post



## Progressive modern Geometry

110 travel	X-Small	Small	Medium	Large
Stack	609.0	613.5	618.5	633.0
Reach	394.0	415.0	445.0	476.0
HTA	68.5	68.5	68.5	68.5
STA	74.5	74.0	73.5	73.5
CSL	430.0	430.0	430.0	430.0
BB Drop	56.5	56.5	54.5	54.5
Fork Length	517.0	517.0	517.0	517.0
Offset	51.0	51.0	51.0	51.0
WB	1092.0	1115.0	1147.0	1184.0



## Detail Design

Low mounted seat stays to promote vertical compliance, with a 'kinked' seatstay design that creates a discontinuity to contribute to that compliance.

Modern "road" aesthetic with tube shaping drawn from the road model line





## Detail Design

Downtube shape is flat and wide, taking full advantage of the extra width in the downtube from the T47 x 88.5 BB system. Slight radius' on the outside and top of the Downtube improve the “hand” or localized tube buckling stiffness

The top tube shape is wide and flat, this allows the top tube to bend under very high loads such as landing a jump to flat, or having a severe frontal impact.

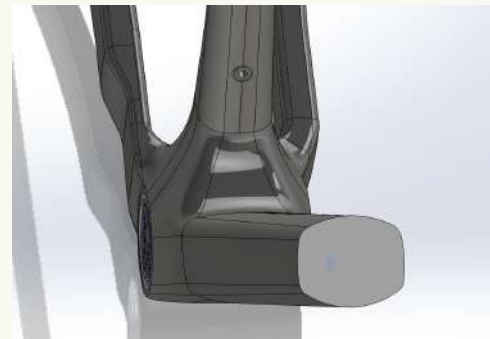

## Detail Design

Ultra wide BB area enabled by the T47 x88.5 mm wide boost friendly BB system.



Boost 148mm rear spacing for proper chainline with excellent tire clearance



## Detail Design

Sram UDH for future compatibility with direct mount RD's

Fully internal cable routing

Flat mount rear brake for exceptionally light single piece chainstay/seatstay junctions. This also removes any comolded aluminum that can cause issues adding to more weight in the frame





BLACK INC





Refined carbon barstem with tuned stiffness, representing a new bench mark for light weight. When combined with our semi-integrated cabling solution using a 1-1/2" upper bearing with a 1-1/8" steerer tube gives the sleekest cockpit on the market. Outfront GoPro style computer mount gives maximum flexibility for lights, cameras or computers.

Lengths	Weight	Backsweep	Rise	Width
60,70,80 & 90mm	320g	8 Degrees	8mm	760mm

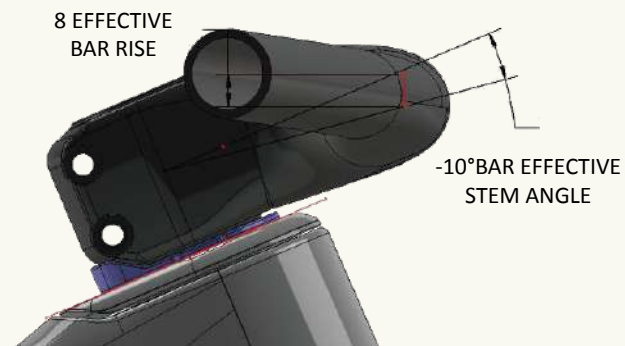
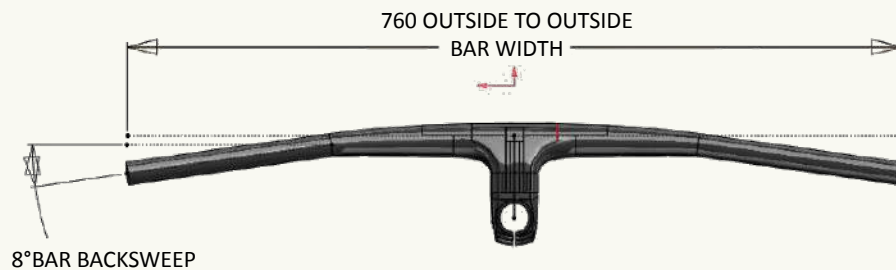

## Black Inc Twenty-Seven

New school XC specific wheelset with the strength for today's modern technical race courses and riders.

- Uncompromising selection of the absolute best quality materials from a tremendously strong Ni-Cr axle to Ceramic Speed Bearings and sapim CX-Ray spokes
- A modern 27mm inner width partnering perfectly with the forward looking Lando Series of MTB's
- Class leading weight of 1460g

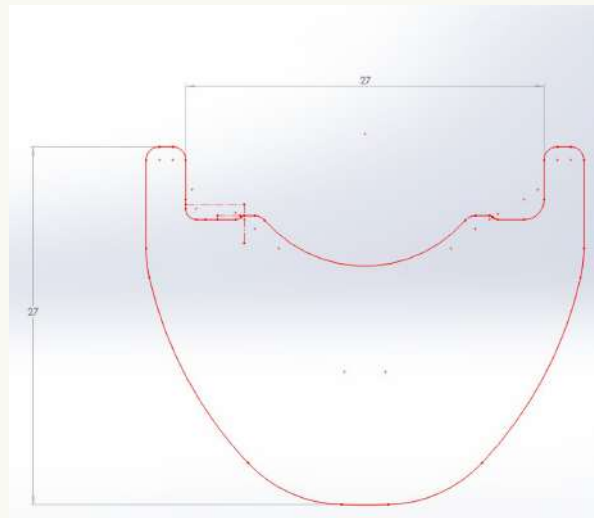

## Black Inc Zero Offset 31.6mm round seatpost

### Zero Offset 31.6 Round Seat post

- Forged alloy top and bottom 2-bolt design clamps give excellent strength at minimal weight
- Compatible with both Round and Oval seat Rails
- Robust and easy to adjust M5 bolts with excellent tool access

Lengths	Setback	Weight
400mm	0 mm	218g



## Black Inc Rigid Fork

- 505 Axle to Crown spacing for modern geometry, Slackens HTA and compensates for a 110mm travel fork
- 15mm TA x 110mm Boost spacing and post mount brake
- Steerer tube hose entry for fully hidden hose routing

Crown to axle	Offset	Weight
505	44 mm	720g

		Distributor price	Dealer	MSRP
Black Inc Rugged Fork MTB	BLACK INC CARBON FIBER MTB FORK BOOST 15 MM x 110 MM CA: 505 MM LENGTH RAKE 44 MM	\$210	\$350	\$600







*FACTORBIKES.COM*